

3311 S 228 Avenue Circle

\$1,878,000



CBSHOME



Map data ©2018 Google



CBSHOME



CBSHOME



CBSHOME

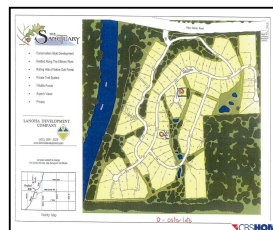

CBSHOME

## Remarks

Enduring value, sophisticated, great design plus individuality are the trademarks of a Ken Oster home and this one is no different. Sensational exterior spaces to enjoy. Casual living in a natural setting with 5 bedrooms, 6 car garage, amazing details & lots of WOW!

## Features & Amenities

<b>County</b>	Douglas County	<b>Bedrooms</b>	5	<b>MLS#</b>	21722280
<b>Subdivision</b>	The Sanctuary	<b>Bathrooms</b>	6	<b>Status</b>	ACTIVE
<b>Living Room Size</b>	25x18	<b># of Rooms</b>	11	<b>Tax Amount</b>	\$3,555
<b>Dining Room size</b>		<b># of Fireplaces</b>	3	<b>Tax Year</b>	\$2,017
<b>Kitchen Size</b>	30x14.2	<b>Garage Spaces</b>	6	<b>Year Built</b>	2018
<b>Master Bedroom Size</b>	16x14.6	<b>3rd Floor SqFt</b>	0	<b>Walk-Out</b>	Yes
<b>Bedroom #2 Size</b>	15x12.6	<b>2nd Floor SqFt</b>	484	<b>Basement</b>	
<b>Bedroom #3 Size</b>	14x13	<b>Main Floor SqFt</b>	2616	<b>Grade School</b>	Skyline
<b>Bedroom #4 Size</b>	19x12.6	<b>Total Finished SqFt</b>	5213	<b>Jr.High School</b>	Elkhorn Valley View
<b>Family Room Size</b>		<b>Finished Below Grade</b>	2113	<b>High School</b>	Elkhorn South
<b>Other Room 1 Size</b>	13.4x21	<b>Lot Dimensions</b>	118x158.70x132.5 4x165		



**Diane Oster**  
CBSHOME  
Diane.Oster@cbshome.com  
402-697-4086



**Andrea Oster**  
CBSHOME  
andrea.oster@cbshome.com  
402-699-4687

Information has not been verified, is not guaranteed and is Copyright (c) 2014 CBSHOME